



Product Specification Sheet

Acclaim Fresnel White



Selecon's most popular Fresnel - available with a white exterior high heat coating and interior black finish.

This option is very much in demand for churches, hotels and meeting rooms and other such venues where the traditional black finish is inappropriate.

Features

110mm diameter lens.

Up to 40% more light output than comparative Fresnel luminaires.

A wide range of beam angles from 6° -60°.

Adjustable yoke balance point.

'Swing-down' door for easy access to lamp or cleaning. Isolates the mains supply when opened.

Captive lamp/ reflector focus system moves on brass bearing provides smooth focus movement.

Rear grab-handle, doubles as handy cable storage.

Lamps: 220V -240V

500W T/25,T/18

11,000 lumens 400hrs average life

650W T/26,T/27

14,500 lumens 600hrs average life

Lamps: 230V -240V

300W M/38

5,200 lumens 2000 hrs average life

300W M/40

10,000 lumens 2000hrs average life

Order Codes

| | |
|-------------------|---|
| 12ACFMSWH | White Acclaim Fresnel |
| 20BDMFW | Barndoor – white |
| 20BDMFWB black | Barndoor - white exterior / interior flaps |
| 15ACSM | Lens safety mesh |
| 20HC | Suspension hookclamp |
| 20SC | Safety bond |

Approvals

Fully tested and compliant to CE standards.



Photometric data

Tests conducted using a standard T/27, 650W, 15,000 lumen lamp.

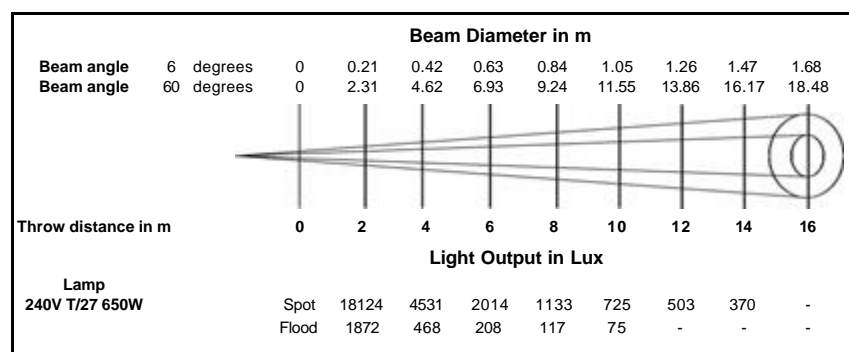

Physical Data

Weight: 2.8kg

Packed Weight: 3.2kg

Carton Size: 420 x 225 x 175

Carton Size Cubic: 0.016

Colour Frame Size: 125mm x 125mm

Included: 1x colour frame, 1x M12 nut & bolt set, instruction leaflet.

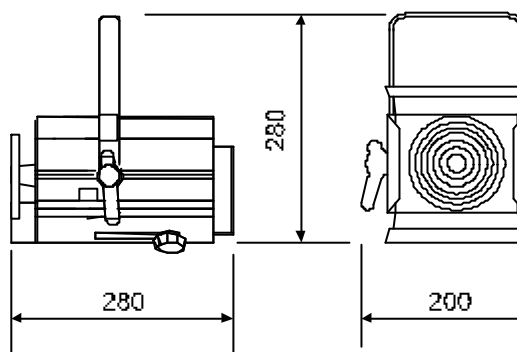

Selecon reserves the right to change the specifications without notice (June 2008).